

Reservations

To book your next event, please contact:

Kari Wolfe

Assistant General Manager /
Director of Conferencing

503-221-0140 or
kwolfe@pdx.edu

Directions

From the EAST —

Portland International Airport (I-205, I-84)

1. Follow signs to Interstate 205 South
2. Continue on I-205 to I-84 West to Portland
3. Follow I-84 to I-5 South
4. Go across the bridge, take Beaverton I-405 split to City Center (left lanes)
5. Take first exit, 4th Avenue
6. At the first light, take a right onto Lincoln
7. University Place is on the right-hand side

From the EAST — Highway 26 — (Mt. Hood, Ross Island Bridge)

1. Follow Highway 26 West to Portland
2. Take City Center Exit
3. Turn right on First Avenue
4. Turn left on Lincoln Street
5. Hotel is on the left-hand side



From the NORTH —

Washington, Vancouver, B.C.

1. Follow I-5 South to Portland
2. Once in Portland, remain in the left lanes
3. Follow signs to I-405 North
4. Take the 4th Avenue Exit
5. Turn right at the first signal, Lincoln Street
6. Hotel is on the right-hand side

From the WEST —

Beaverton, St. Helens (Highway 26)

1. Follow Highway 26 East to Portland
2. Take Market Street/City Center Exit
3. Turn right on Fifth Avenue
4. Turn left on Lincoln Street before freeway signs
5. Continue through signal
6. Hotel is on the right-hand side

From the SOUTH — Salem

1. Follow I-5 North
2. Take City Center Exit
3. Follow signs to I-405 North
4. Take 4th Avenue (immediate right)
5. Turn right at signal onto Lincoln Street
6. Hotel is on the right-hand side

Parking

University Place has 239 parking spaces, including ADA parking spaces available to conference attendees and their guests for a daily fee.

University Place at Portland State University is an educational conference center with 8,000 square feet of conference space, a restaurant, and 235 guest rooms.



University Place
310 SW Lincoln Street
Portland, Oregon 97201
503-221-0140
www.uplace.pdx.edu



University Place can accommodate:

- ◆ Educational conferences for academic institutions and state and government agencies
- ◆ University faculty and staff
- ◆ Visitors to Portland State University, and
- ◆ Alumni and friends of the University



University Place is the southeast anchor of the Portland State campus. The facility is located seven blocks from the heart of downtown Portland and within Fareless Square, an area where public

transportation—buses, streetcars, and light rail—is free. University Place is also a five-minute commute from Oregon Health & Science University.

University Place facilities

- ◆ 235 guest rooms
- ◆ Three executive suites
- ◆ ADA-accessible rooms
- ◆ University Place Grill, serving Northwest specialties
- ◆ University Place Lounge
- ◆ Twenty-four hour fitness room
- ◆ Seasonal heated pool
- ◆ Gift shop



Portland State University

Portland State University, Oregon's only urban university, is the largest and most diverse in the state system. The University's position in Oregon's economic and cultural center allows for deep community engagement and the creation of partnerships with hundreds of organizations throughout the region—partnerships that give PSU students valuable learning opportunities as they solve real-world problems of business and community. Portland State offers more than 100 undergraduate, master's, and doctoral degrees, as well as graduate



The Urban Center at Portland State University

certificates and continuing education programs. PSU serves more students and confers more master's degrees annually than any other Oregon university.

Conference facilities

PSU's University Place provides conference and meeting facilities for groups as small as five and as large as 400. The 8,000-square feet of meeting and banquet space include eight meeting rooms and a 3,793-square-foot ballroom. Rooms are equipped with flexible sound systems, adjustable lighting, and telephone outlets. Meetings are staffed by professional conference services personnel, including A/V technicians. Our Business Center offers copier, fax machines, and high-speed Internet access.

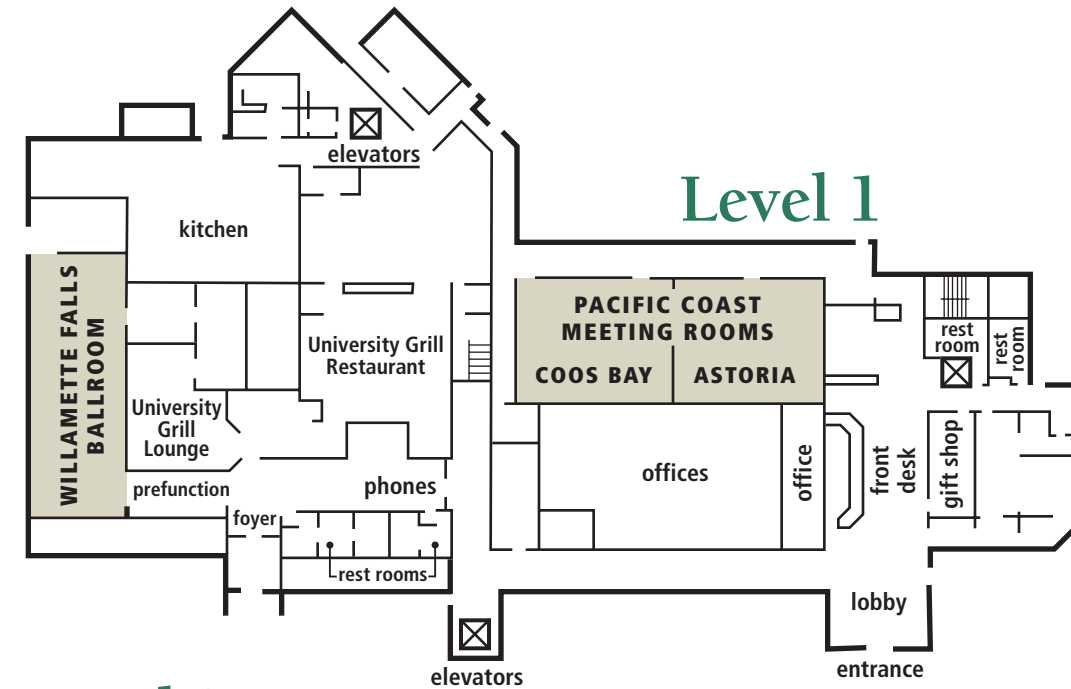

Level 2

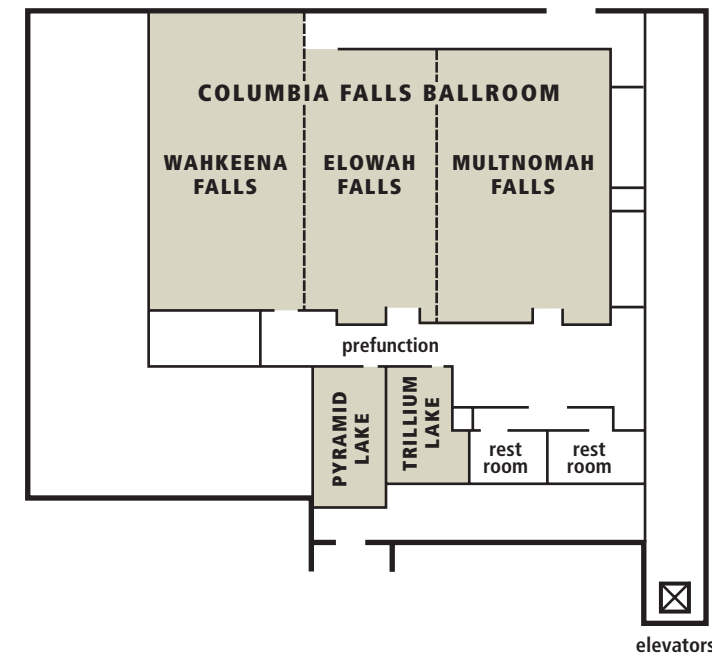

Name of Room	Dimensions	Square Feet	Ceiling Height	Reception	Rounds	Banquet	Classroom	Theater	Conference	U-Shape
Columbia Falls Ballroom	76' x 48'	3,793	10'8"	350	320	340	200	400	-	-
Wahkeena Falls	54' x 24'	1,300	10'8"	100	100	100	72	125	40	40
Elowah Falls	48' x 20'	960	10'8"	50	70	78	40	100	40	30
Multnomah Falls	48' x 32'	1,536	10'8"	150	120	128	90	180	40	50
Coos Bay	36' x 25'	900	8'	50	60	68	30	70	25	25
Astoria	36' x 25'	900	8'	50	60	68	30	70	25	25
Pyramid Lake	26' x 12'	312	8'	-	-	-	9	25	16	-
Trillium Lake	19' x 14'	300	8'	-	-	-	9	20	16	-
Willamette Falls Ballroom	24' x 70'	1,680	10'4"	170	120	128	96	190	40	50